

Introduction

Reciprocating machinery creates large vibration forces which frequently require isolation from the surrounding building structure. Large forces or doubtful machine stability may require the use of an inertia block of steel or concrete to provide low dynamic amplitude on the machine whilst providing a stable and stiff base which may be supported by steel springs or other resilient devices. Many applications will operate quite satisfactorily with only an undamped steel spring support, but where system resonances may be excited to unacceptable amplitude due to the varying speed of the machine or transient conditions, damping must be incorporated.

Our range of steel springs and damper units for the support of machines are as diverse as laboratory balances and turbo generator sets. Although standard components are used, each system is individually designed and analysed to ensure that the correct stiffness and masses are provided to permit proper operation of the mounted equipment. First introduced over 40 years ago, these systems are now used world over.

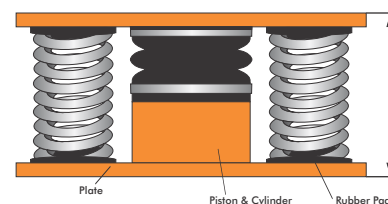
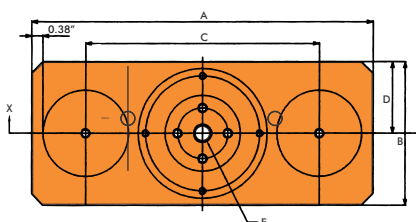

Features

- Loads up to several hundred tonnes
- Up to 20% of critical damping
- Concrete foundation isolation
- Systems incorporate free standing spring units with viscous dampers.
- Simple to install and reliable
- Vertical natural frequencies in the range 1.4 to 3.0 Hz.
- Lower foundation may be built less massively.
- Life of mounting system greater than life of machinery.

Applications

- Analytical Balances & Microscopes
- Fans & Blowers
- Boiler Feed Pumps
- Coal Crushers & Pulverizers
- Turbo Generating Sets & Generators
- Forging Hammers & Heavy Presses
- Centrifuges
- Technical Floors
- Large Machinery
- Drop Hammers
- Test Beds
- Building Isolation

Unit Type	Load Range (LBS)	Deflection (INCH)
EFVD2-25/60	88-132	0.50-1
EFVD2-25/120	154-264	0.50-1
EFVD2-25/200	264-440	0.50-1
EFVD2-25/320	418-704	0.50-1
EFVD2-25/500	528-1100	0.50-1
EFVD2-25/600	792-1320	0.50-1
EFVD2-25/800	1056-1760	0.50-1
EFVD2-25/1000	1320-2200	0.50-1
EFVD2-25/1200	1584-2640	0.50-1
EFVD2-25/1600*	2112-3520	0.50-1
EFVD2-25/2000	2640-4400	0.50-1
EFVD2-25/2400	3168-5280	0.50-1
EFVD2-50/200	352-440	1.57-2
EFVD2-50/400	704-880	1.57-2
EFVD2-50/600	1056-1320	1.57-2
EFVD2-50/800	1408-1760	1.57-2
EFVD2-50/1000	1760-2200	1.57-2
EFVD2-50/1200	2112-2640	1.57-2
EFVD2-50/1600	2838-3520	1.57-2
EFVD2-50/2000	3520-4400	1.57-2

Compliance - Springs designed according to BS 1726 (Part 1) and recommendations made by SAE (US) and ASHRAE

- Due to policy of continual improvement, the specifications are subject to change without prior notice.
- Measurements are subject to 5% tolerance.
- To achieve good sound suppression do not over load fitting.